



File Name: Can-am spyder manual.pdf

Size: 2027 KB

Type: PDF, ePub, eBook

Category: Book

Uploaded: 20 May 2019, 15:12 PM

Rating: 4.6/5 from 695 votes.

Download Now!

Please check the box below to proceed.



I'm not a robot



reCAPTCHA
Privacy - Terms

Book Descriptions:

Can-am spyder manual



In Canada, products are distributed by Bombardier Recreational Products Inc. In USA, products are distributed by BRP US Inc. This is a nonexhaustive list of trademarks that are the property of Bombardier Recreational Products Inc. It is backed situation which, if not avoided, Bombardier Recreational could result in minor or moderate Products Inc. BRP warranty and a injury. Check our website at www.canam.brp.com for more information about upcoming training course availability. If you cannot take a training course specifically designed for the Spyder roadster, it is a good idea. It is important to know the location and operation of all controls, and to develop and practice smooth and coordinated use of them. Steer the handlebar in the direction you want to go. 2 Throttle The throttle is the right handgrip, and it controls engine speed. Hold in position. It allows to engage or release the electric parking brake. NOTE A key barrel is supplied in the glove box to use with the BRP optional trailer. Turn the cruise control to ON by sliding the cruise control button to the right. Otherwise, this could cause a vehicle loss of control. NOTE You can manually throttle the engine if you need to go faster than the set speed. To select low If the cruise control was cancelled and beams, push the switch to the down the cruise control switch is still at the position. The audio volume will mute. From the mute setting, pressing the UP button will reset the audio volume to its last setting. 11 Reverse Button The reverse button is located on top of the left handlebar housing. For minimum heat, press the LO intensity side of the switch. For maximum heat, press the HI intensity side of the switch. Always keep on observing the traffic and make sure the surrounding is clear and safe before doing so. Default riding Digital Display Description The display is divided in several areas Audio option package as follows. <http://www.ucitelskenoviny.cz/www/userfiles/dish-500-plus-manual.xml>

- **can-am spyder manual transmission for sale, can-am spyder manual transmission, can am spyder manual, can am spyder manual pdf, can am spyder manual vs semi automatic, can am spyder manual vs automatic, can am spyder manual or automatic, can am spyder manual download, can am spyder manual for sale, can am spyder service manual, can-am spyder manual, can-am spyder manual pdf, 2015 can am spyder owner manual, 2008 can am spyder manual, can-am spyder repair manual, can am spyder 2013 manual, can am spyder 2014 manual, can am spyder 2017 f3 manual.**

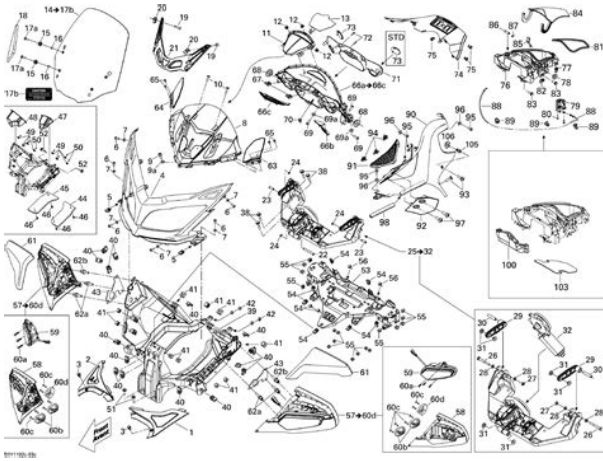

CB optional Trip meter Preferences only available when vehicle is stopped, except for. Display We recommend you practice selecting 6 Trip Meter some functions on the infotainment Distance travelled in kilometers or center before getting on the road. You miles since the last reset. Two areas at the bottom can be used to display 2 of these 3 functions Engine speed, radio current preset or radio current frequency. To change the display, re PREFERENCES SCREEN p.33 fer to 1 Engine Coolant Temperature. The radio player is connected to the vehicle au will remain tuned to that station. Under all riding conditions, the needle should stay within this range. When done, close cover then push on the lower end of glove box to latch it. NOTE Be aware that objects may have moved while riding. Pay attention not to drop objects while opening the cover. Always latch the cover after usage. When finished, lock the latches if de sired. Two helmet hooks are provided under the seat to secure a helmet. Flip the footpeg downward. Open seat. Starting and Stopping the Engine Starting the Engine WARNING Exhaust gas contains poisonous carbon monoxide that can rapidly accumulate in an enclosed or poorly ventilated area. Do not while starting the engine. The centrifu 3. Follow the NOTE The breakin inspection is per. Higher spring preload provides a firmer ride and is recommended for heavy loads, rough road conditions and more challenging riding. This might damage the air suspension. Releasing the switch will keep the set point after a few seconds. NOTE On models without separate analog gauges, the temperature bar gauge will be replaced by the suspension bar gauge. This section will help vehicles behind you that may not be you understand some of the vehicle able to stop as quickly. Surfaces With Poor Traction Proper tire inflation pressure and tread The grip of tires on the road surface condition are important for maintaining limits the maximum braking. <http://www.expert-geo.pl/userfiles/dish-625-dvr-manual.xml>



Large and rapid steering handlebar movements can cause the vehicle to go out of control, spin, tip or roll over. Excess Speed The VSS does not control the vehicle speed, except when SCS intervenes.

Even if your blood alcohol level is not over the legal limit, your judgment and skills are impaired by any alcohol consumption. You must be physically able to operate all controls, turn the handlebar through the full range of steering, mount and dismount, and monitor your surround. Even though the vehicle is more than helmet use significantly reduces stability at low speeds than a motorcycle the risk of brain injury. Other than the wind, sun, heat, cold and abrasion-resistant protective gear flying objects. Gloves that fit snugly made of synthetic fabrics are good will improve grip on the handlebar and choices, too. A dry rider will be much more comfortable and alert than a rider who is wet and cold. One or two-piece styles are available, and those designed specifically for motorcycling are best. High-visibility or orange or yellow colors are good choices. Always keep both hands and both feet in position so that you can operate the controls easily. The wrist should typically be aligned straight with the arm this position helps you apply the amount of throttle you want. You will be controlling your right foot pressing the brake pedal, movement using only the clutch in the pull in and hold the clutch lever. Directions This exercise is similar to what you did before, except you'll be applying the brake more firmly, working up to braking as hard as possible. Directions 6 m 20 ft Weave 1. Follow agram below. Do not use any fixed or the same process and shift up or down hard, heavy objects as markers for this one gear at a time. Have your helper stand at a safe distance away e.g., beyond the end of your practice area. Directions This exercise is similar to what you did before, except you'll be applying the brake more firmly, working up to braking as hard as possible.

You may want to use the parking lot aisles for this exercise rather than riding in the spaces. When you do not apply throttle while downshifting, engine braking will slow the vehicle. Many riding more weight, and visibility may of these strategies are similar to those be limited in fog, in curves or at night. Make sure turn signals able to stop as quickly as the Spyder are off after you have completed your roadster. When you In dim light, such as at night, at dawn are being followed by a large vehicle, or dusk, or in poor weather such as rain passing vehicles may not be able to or fog, you may be harder to see. This can make through turns. Going up hills, a lower gear can too fast. Adjust throttle as you release help maintain enough power. In curves, do not try to follow the road. As with other vehicles, the the path of motorcycles. Avoid hard braking, downshifting, or sharp steering. If a front tire fails, the vehicle may tend to pull in the direction of the failed tire, so you will need to maintain a firm grip on the handlebar to control your direction. Operating with Extra Weight Carrying a passenger or heavy cargo. Be sure the passenger is wearing appropriate protective gear. The passenger should wear all of the protective gear recommended for the operator, particularly a helmet. It is very convenient to store items that could be needed quickly during a ride such as money for pay toll. NOTE A key barrel is supplied in the glove box to use with the BRP optional trailer. It is easier to destabilize an The use of any other trailer could empty trailer. When accelerating, it is damage the vehicle or interfere normal to shift at a higher RPM to avoid with the proper operation of the loading excessively the engine. When starting uphill from a stop, more clutch slippage is needed to prevent engine stalling. When riding uphill, more frequent downshift will be required so that engine has enough power to minimize speed variations.

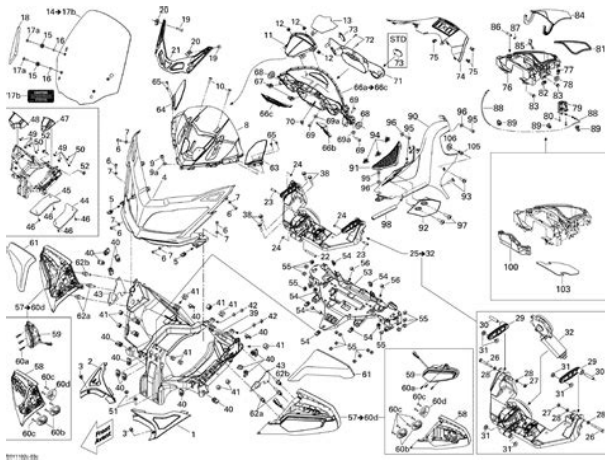

<https://www.thebiketube.com/acros-3n1-pjt-manual>

A scale can be Use only a BRP hitch or a BRP ap used to measure the weight at the proved equivalent. Unlike a typical motorcycle, you with those approved by BRP should make it common practice obtained from authorized to brake and turn at the same time. CanAm roadster dealer. True False True False 12. Under normal conditions,. To stop quickly, press the brake 13. True pedal only. 14. 1 Make sure your lights and False reflectors are clean. You should do a preride inspection 2 Use your high beams whenever every time you ride. In addition, passengers can protect themselves by wearing seat belts. You should expect that riding the Spyder roadster is much riskier than riding in a car and that the risk of injury is more like the risk of injury when riding a motorcycle. Any person who rides this vehicle should read and understand this in formation on the vehicle before riding.Pull it out to read it, and be sure to securely put it back before riding. Use the Safety Card to review key information and when you are teaching new operators and passengers how to ride the vehicle. See an authorized CanAm roadster dealer.In the USA, if you believe that your ve hicle has a defect which could cause a crash or could cause injury or death, you should immediately inform the Na tional Highway Traffic Safety Adminis. This could break it.If possible, use chains or additional CAUTION If you need to push straps to attach the straps to the. Firmly attach the rear wheel 1. Strap around the rim of each front wheel tiedown strap to the rear of the and attached to the front of trailer trailer with a ratchet. Proper maintenance is the owners responsibility. The maintenance schedule does not exempt the preride inspection. WARNING Failure to properly maintain the vehicle according to the maintenance schedule and procedures can make it unsafe to operate. NOTE The breakin inspection is at the expense of the vehicle owner. We recommend that this inspection be signed by an authorized CanAm dealer.

<http://elllanorestaurants.com/images/britony-combi-80-parts-manual.pdf>

Can-Am Spyder



Service Repair Manual

In LIMP HOME, the engine RPM is limited and therefore the vehicle speed. No warranty will be allowed by Bombardier Recreational Products Inc. In California, new motor vehicles must be designated, built and equipped to meet the States stringent antismog standards. Furthermore, BRP and its affiliates may use its customer list to distribute marketing and promotional information about BRP and related products. We will ask you to provide your name, address, phone number, the vehicle identification number and the date it was stolen. It is fully printable, print 1 page, 1 chapter or print the entire manual and put it in a 3ring binder. Once you download your manual it is yours forever. The same one your local dealer uses, just in electronic form. The same one your local dealer uses, just in electronic form. In addition to the 2011 repair and maintenance manual I have included the largest collection of 2012 Spyder material available anywhere, please read below for whats included. RT Touring Series, NOT RS see the manual above for it BRP has decided not to make a new repair manual for 2012. In addition to the 2011 repair and maintenance manual I have included the largest collection of 2012 Spyder material available anywhere, please read below for whats included. The same one your local dealer uses, just in electronic form. The same one your local dealer uses, just in electronic form. The same one your local dealer uses, just in electronic form. Exploded views with part numbers of EVERY PART. The expanded dealer only fault code chart service bulletin 2014 Owners manuals 2014 Dealer Only color mechanic introduction to the new 1330 3 cylinder power plant with indepth explanations and exploded views of the inner workings of the new engine. The same one your local dealer uses, just in electronic form. The same one your local dealer uses, just in electronic form. The same one your local dealer uses, just in electronic form.

The same one your local dealer uses, just in electronic form. We have combined the base manuals with all needed supplemental manuals into one easy to use manual. The same one your local dealer uses, just in electronic form. The same one your local dealer uses, just in electronic form. We have combined the base manuals with all needed supplemental manuals into one easy to use manual. The same one your local dealer uses, just in electronic form. The same one your local dealer uses, just in electronic form. This manual contains hundreds of pages of additional content that the books never did including The full BRP 870 page repair and maintenance manual. The same one your local dealer uses, just in electronic form. This manual contains hundreds of pages of additional content that the books never did including The full BRP 761 page repair and maintenance manual. The same one your local dealer uses, just in electronic form. The same one your local dealer uses, just in electronic form. This manual contains hundreds of pages of additional content that the books never did including The full BRP 746 page repair and maintenance manual. The same one your local dealer uses, just in electronic form. This manual contains hundreds of pages of additional content that the books never did including The full BRP 655 page repair and maintenance manual. The same one your local dealer uses, just in

electronic form. Online Parts Manual with exploded views with part numbers of EVERY PART! This is the only part of the manual that requires online access to use 2020 Owners manuals 2020 Dealer Only whats new technical update presentations Dealer Only expanded diagnostic fault codes 2020 Sales Brochure Top Copyright 2016.BRP Manuals All Rights Reserved. By browsing this site, you are agreeing to our use of cookies in accordance with our Privacy Policy. Find out more on cookies and how to manage your settings on our Cookie Policy.

<https://gsoam.ge/wp-content/plugins/formcraft/file-upload/server/content/files/1626fe90549a37---bosc-e-wave-clock-radio-manual.pdf>

The references used may be made clearer with a different or consistent style of citation and footnoting. September 2009 Learn how and when to remove this template message . The vehicle has a single rear drive wheel and two wheels in front for steering, similar in layout to a modern snowmobile. The Spyder uses an ATV like chassis.In California, Delaware, Nevada, and South Carolina only a regular drivers license is required—however, helmet laws apply in California as they do for all motorcyclists.Some of the lines having additional trim packages, which can result in Spyders, even in the same line, having quite a different look. Additionally, in 2018, CanAm started producing a new lowercost line named the Ryker. It is intended for a younger entrylevel demographic and does not bear the Spyder moniker.This could be compared to a Cruiser motorcycle, where the seating is much lower to the ground. There are several trim packages available in the F3 series, such as the base model F3, the F3S, the F3S Special Series, the F3T, and the F3Limited. This could be compared to a Touring motorcycle.The styling and seat position is more like a conventional sport bike. It was discontinued in 2016. This could be compared to a Sport touring motorcycle. It was discontinued in 2016. Please help improve it by removing promotional content and inappropriate external links, and by adding encyclopedic content written from a neutral point of view. July 2009 Learn how and when to remove this template message Instead, a paddleshifter located on the lefthand grip at the thumb position is used to shift press paddle forward with the thumb to shift UP, press paddle backward with the index finger from the front to shift down.It is a onedownfiveup system with real reverse.Instead, a paddleshifter located on the lefthand grip is used to upshift and downshift see Spyder SE5 for detailed operation.

<aothuatdanang.com/upload/files/95ti-treadmill-user-manual.pdf>

Please review the source and remedy this by editing this article to remove any nonfree copyrighted content and attributing free content correctly, or flagging the content for deletion. Please be sure that the supposed source of the copyright violation is not itself a Wikipedia mirror. December 2015 Retrieved 20120911. By using this site, you agree to the Terms of Use and Privacy Policy. Our payment security system encrypts your information during transmission. We don't share your credit card details with thirdparty sellers, and we don't sell your information to others. Please try again.Please try again.Printed Pages Ruined. Print a Fresh Copy the Next Time.Buy directly from TechSpark WorkshopIn order to navigate out of this carousel please use your heading shortcut key to navigate to the next or previous heading. In order to navigate out of this carousel please use your heading shortcut key to navigate to the next or previous heading. Register a free business account Please try your search again later.But unlike a traditional paper manual, this software can quickly search any term, locating the information you need in seconds. No more thumbing aimlessly through page after page as you would with a traditional manual. You can also create custom bookmarks and find that information you need over and over again, quickly and easily. TechSpark Studio programs also includes an integrated zoom and pan tool to easily focus on every detail clearly as possible. One of the best features is the ability to print specific pages or the entire program and if the pages get dirty and greasy, simply print a fresh copy the next time you need the information. TechSpark Studio programs dont just include all of the model specific information for your vehicle you have, but also extensive basic service and maintenance information that can help with any general service and

repair you need to accomplish.

Plus gain quick access to the full online parts catalog and complete wiring diagrams for your vehicle. If you are a seller for this product, would you like to suggest updates through seller support? To calculate the overall star rating and percentage breakdown by star, we don't use a simple average. Instead, our system considers things like how recent a review is and if the reviewer bought the item on Amazon. It also analyzes reviews to verify trustworthiness. Please try again later. Sandee Soloway 5.0 out of 5 stars I try to do some of my own work, and this has the info. The Spyder uses an ATV-like chassis. The Spyder was officially debuted on February 2007. However, before you tinker with your Spyder make sure you have a CanAm Spyder workshop manual to get the job done right. There are four model lines of Spydery; some of the lines have additional trim packages, which can result in them having quite the variety of looks. In 2018, CanAm started producing a new lower-cost line named the Ryker. It is intended for a younger demographic and does not bear the Spyder moniker. The Spyder RS series was a sport version with styling and seat position is more akin to a conventional sportbike. The Spyder ST series was a sport-touring hybrid variant of the Spyder, with removable saddlebags and an upright seat. This could have been compared to a sport-touring motorcycle. However, both were discontinued in 2016. The Spyder RT series was a touring version, with a top case and integrated saddlebags. Comparable to a touring motorcycle, there were two Trim Packages in the RT Line, the RTS and the RTLimited. Some liken it to a Cruiser motorcycle, where the seating is situated much lower to the ground. There are several trim packages offered in the F3 series, such as the base model F3, the F3T Touring, the F3S Special, F3L Limited, and an F3 Limited 10th 2017 Anniversary Edition. There are two trim packages offered for the Ryker, the base model, and the Rally Edition.

The CanAm brand continues to be a staple of the Spyder's appeal and doesn't appear to be going anywhere anytime soon. Make sure you grab your CanAm service manual today. To start viewing messages, I finally have my 2009 Spyder delivered, I don't have much history on this spyder so I would like to go ahead and do the maintenance so I have a fresh baseline. Does anyone have an electronic version of the manuals you could send me as my spyder didn't come with them. I'm planning on oil change to start off with. It seems to drive well, had a pretty hard clutch where it catches at the end range of the release. Stalled it out a few times because I guess I was not giving it enough throttle. It has 9k miles on it. I'll have to post some pictures soon. This thing is a beast and when I say one of a kind, I mean one of a kind. This will cover the spyder. Not knowing much about your ride I would check the clutch lever position as it is adjustable or just flush the system and add new DOT4 fluid. Welcome to the world of spydery Lots of great info there. I finally have my 2009 Spyder delivered, I don't have much history on this spyder so I would like to go ahead and do the maintenance so I have a fresh baseline. Does anyone have an electronic version of the manuals you could send me as my spyder didn't come with them. I know later model manuals are there. If not using the BRP Oil it should be rated JASO MA2!!! MA is NOT MA2 MA2 is best for Spyder engine. Good luck I sold mine with 35,000 miles and loved it! Sea Doo GTISE 90 Jet Ski!! Feedback Buttons provided by. Super PM System provided by. Digital Point modules Sphinx-based search. SPORT MODE FUNFACTOR UNLEASHED Turn on the Sport Mode and feel your adrenaline surge as you tame twisting roads or perform controlled rear tire spins, all while maintaining your balance and peace of mind. It's our most permissive stability system setting yet.

FOX PODIUM SHOCKS PERFORMANCE, COMFORT AND CONTROL Sport-tuned gas-charged front shocks feature anodized aluminum bodies and threaded preload adjustments. CRUISE CONTROL RELAX AND ENJOY Automatically set a comfortable pace so you can just sit back and enjoy the scenery. PREMIUM WHEELS TWOTONE PERFECTION These wheels evoke boldness and confidence. They're machined, deep black high gloss, for a superpremium look. You also get the front fenders with integrated LED light pipes for greater visibility and a striking look. SEATING CLASSIC

STYLE WITH MODERN COMFORT Allblack saddle features embossed quilting for a sleek, modern look. Delivers all day comfort and excellent lumbar support. Rotax 1330 ACE InLine 3 Cylinder Engine Custom riding position with UFit System New Sport Mode Cruise Control Distinctive "S" Trim Signature Machined, Deep Black High Gloss Front Wheels Refined Front Fenders with LED Lights Black Embossed Suede Seat Engine. Something went wrong. View cart for details. All Rights Reserved. User Agreement, Privacy, Cookies and AdChoice Norton Secured powered by Verisign. I got my answers right away. Highest Praise Got me through the top end rebuild of my sled. Thank you ever so much for your fast replies, excellent products, and perfect service. Will definitely recommend to friends. We will be recommending you to others!! I expected a few days for a response, not minutes. A definite winner! Buy with confidence!!! Unlike other manuals on the internet my manuals don't need a password to view or print and you can back them up any way you see fit to make sure it's always there when you need it. In addition to the 2011 repair and maintenance manual I have included the largest collection of 2012 Spyder material available anywhere, please read below for what's included. In addition to the 2011 repair and maintenance manual I have included the largest collection of 2012 Spyder material available anywhere, please read below for what's included.

The same one your local dealer uses, just in electronic form. The same one your local dealer uses, just in electronic form. The same one your local dealer uses, just in electronic form. All Rights Reserved.

<http://www.drupalitalia.org/node/79946>